

UNIT, DIRECT SUPPORT, AND GENERAL SUPPORT MAINTENANCE
REPAIR PARTS AND SPECIAL TOOLS LIST
TRUCK, 5-TON, 6X6, M809 SERIES TRUCKS (DIESEL)

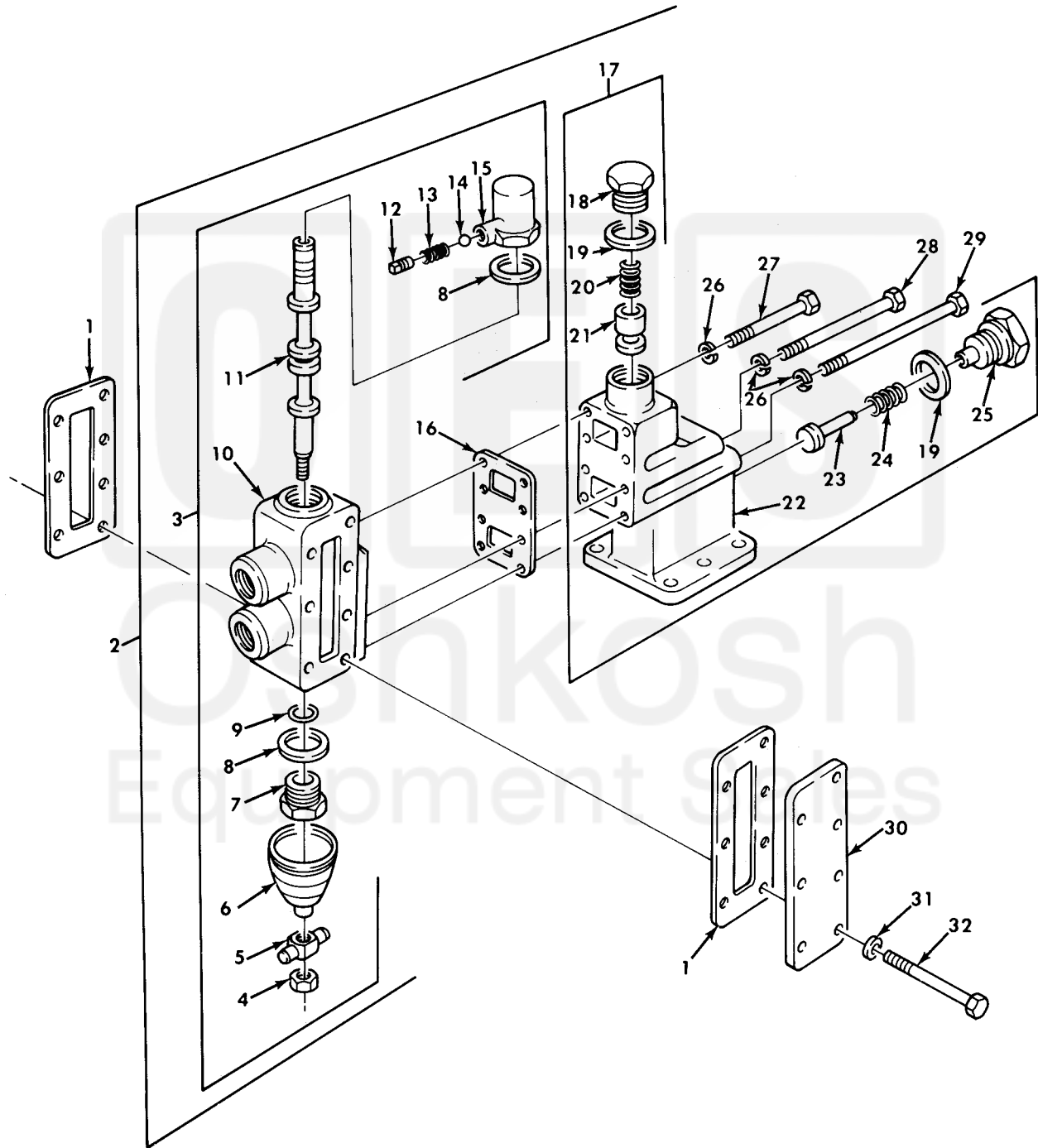

Figure 381. Dump Hoist Control Valve Assembly and Mounting Hardware.

(1) ITEM NO	(2) SMR CODE	(3) NSN	(4) CAGEC	(5) PART NUMBER	(6) DESCRIPTION AND USABLE ON CODE (UOC)	(7) QTY
GROUP 2001 HOIST,CRANE,OR WINCH ASSEMBLY						
FIG. 381 DUMP HOIST CONTROL VALVE ASSEMBLY AND MOUNTING HARDWARE						
1	PAFZZ	5330-00-740-9089	19207	7409089	GASKET..... UOC: 627, 633	2
2	PAFFH	4820-00-351-7832	19207	8758395	VALVE,HOIST CONTROL..... UOC: 627, 633	1
3	PAFZZ	4810-00-117-0251	61465	M2020479	. VALVE,LINER,DIRECT..... UOC: 627, 633	1
4	PAFZZ	5310-00-732-0560	96906	MS51968-14	. . NUT,PLAIN,HEXAGON..... UOC: 627, 633	1
5	PAFZZ	2520-00-740-9087	19207	7409087	. . TRUNNION VALVE SPOO..... UOC: 627, 633	1
6	PAFZZ	9390-00-563-4641	19207	8329894	. . BELLOWS,PROTECTION..... UOC: 627, 633	1
7	PAFZZ	5365-00-403-5798	19207	7409162	. . BUSHING,MACHINE THR..... UOC: 627, 633	1
8	PAFZZ	5365-00-182-9635	19207	7409080	. . SPACER,RING..... UOC: 627, 633	2
9	PAFZZ	5331-00-292-0570	21450	501461	. . O-RING..... UOC: 627, 633	1
10	XAFZZ		19207	7409084	. . BODY..... UOC: 627, 633	1
11	XAFZZ		19207	7409085	. . SPOOL,VALVE,CONTROL..... UOC: 627, 633	1
12	PAFZZ	4730-01-047-3667	72582	113175	. . PLUG,PIPE..... UOC: 627, 633	1
13	PAFZZ	5360-01-205-9507	19207	7409073	. . SPRING,HELICAL COMP..... UOC: 627, 633	1
14	PAFZZ	3110-00-100-6153	76760	147487	. . BALL,BEARING DUMP HOIST CONTROL VALVE..... UOC: 627, 633	1
15	XDFZZ		19207	7409086	. . CAP,WINCH..... UOC: 627, 633	1
16	PAFZZ	5330-00-740-9081	19207	7409081	. GASKET PUMP ADAPTER..... UOC: 627, 633	1
17	PFZZ	4320-01-141-5311	19207	8758393	. VALVE HEAD,HYDRAULI..... UOC: 627, 633	1
18	PAFZZ	5365-00-740-9079	19207	7409079	. . PLUG,MACHINE THREAD..... UOC: 627, 633	1
19	PAFZZ	5365-00-182-9635	19207	7409080	. . SPACER,RING..... UOC: 627, 633	2
20	PAFZZ	5360-00-999-6470	19207	7409078	. . SPRING,HELICAL,COMP..... UOC: 627, 633	1
21	PAFZZ	4820-00-740-9077	19207	7409077	. . PLUNGER PUMP ADAPTE..... UOC: 627, 633	1
22	PFZZ	2590-00-933-9580	19207	8758394	. . BODY,ADAPTER,HYDRAU..... UOC: 627, 633	1
23	PAFZZ	4810-00-740-9056	19207	7409056	. . PLUNGER CYLINDER BA..... UOC: 627, 633	1
24	PAFZZ	5360-00-597-1235	19207	8330242	. . SPRING,HELICAL,COMP..... UOC: 627, 633	1
25	PAFZZ	5365-00-740-9057	19207	7409057	. . PLUG,MACHINE THREAD..... UOC: 627, 633	1
26	PAFZZ	5310-00-637-9541	96906	MS35338-46	. WASHER,LOCK..... UOC: 627, 633	8
27	PAFZZ	5305-00-269-3219	96906	MS90725-69	. SCREW,CAP,HEXAGON H..... UOC: 627, 633	4
28	PAFZZ	5305-00-964-0503	80204	B1821BH038C500N	. SCREW,CAP,HEXAGON H..... UOC: 627, 633	2

(1) ITEM NO	(2) SMR CODE	(3) NSN	(4) CAGEC	(5) PART NUMBER	(6) DESCRIPTION AND USABLE ON CODE (UOC)	(7) QTY
29	PAFZZ	5305-00-415-1482	19207	8758397	. SCREW, CAP, HEXAGON H..... UOC: 627, 633	2
30	PAFZZ	5340-00-740-9088	19207	7409088	COVER, ACCESS..... UOC: 627, 633	1
31	PAFZZ	5310-00-637-9541	96906	MS35338-46	WASHER, LOCK..... UOC: 627, 633	7
32	PAFZZ	5305-00-269-3250	96906	MS90727-74	SCREW, CAP, HEXAGON H..... UOC: 627, 633	7

END OF FIGURE

